

Top of the line grease gun for heavy industrial applications

- Built Tough**
- Barrel with 0.049" (1.2 mm) wall thickness
 - Heavy duty follower spring
 - High tolerance CNC machined, aluminium die cast head
 - Rolled threads for quick & easy re-loading

Variable Stroke
Convenient greasing even in tight spaces with limited movement of handle

- Available in 2 choices**
- 6" (150 mm) steel extension & coupler
 - 12" (300 mm) x 0.33" (8.5 mm) flexible hose & coupler

SPECIFICATIONS

DEVELOPS	UPTO 10,000 PSI	UPTO 690 BAR
DELIVERS	UPTO 1 OZ. / 28 STROKES	UPTO 1 GM / STROKE



FILLING OPTIONS

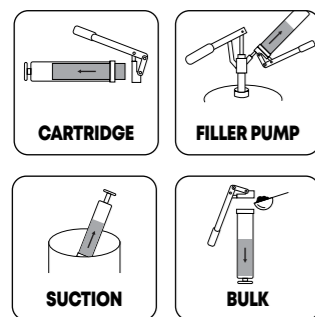

Aluminium die cast head with bulk loader and air bleeder valve

VARIANTS



NEW!

ORDERING INFORMATION

CAT NR.	ORD NR.	CAT NR.	ORD NR.	CARTRIDGE CAPACITY		BULK CAPACITY (CM ³)	THREADS	BOX QTY.
				(OZ.)	(GMS)			
6" (150 MM) STEEL EXTENSION & COUPLER		12" (300 MM) FLEXIBLE HOSE & COUPLER						
* G1R/HD/B	42700	G1F/HD/B	42720	14	400	500	1/8" BSPT	16
* G1R/HD/M	42701	G1F/HD/M	42721	14	400	500	M10 x 1	16
* G1R/HD/N	42702	G1F/HD/N	42722	14	400	500	1/8" NPT	16
* G4R/HD/B	42780	G4F/HD/B	42785	-	450	650	1/8" BSPT	16
G10R/HD/B	42750	G10F/HD/B	42760	14	400	750	1/8" BSPT	10
G10R/HD/M	42751	G10F/HD/M	42761	14	400	750	M10 x 1	10
G10R/HD/N	42752	G10F/HD/N	42762	14	400	750	1/8" NPT	10
◆ G18R/HD/M	42753	◆ G18F/HD/M	42763	-	600	700	M10 x 1	10

* Best Seller ◆ New